

CATTARAUGUS COUNTY DEPARTMENT OF PUBLIC WORKS ISCHUA 5 PLUNGE POOL REHABILITATION

**TOWN OF LYNDON
STATE ID: 025-2980**

MARCH 2019

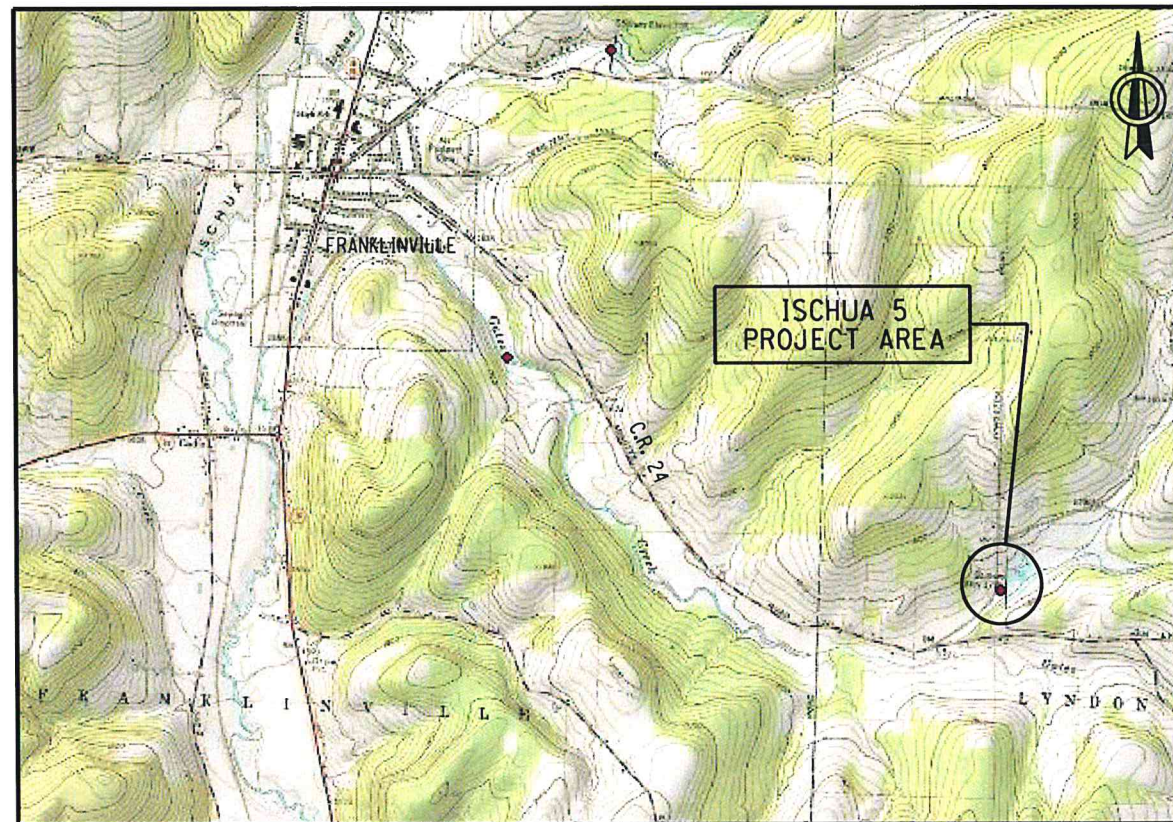

PREPARED BY:



280 East Broad Street
Suite 200
Rochester, New York 14604

office: 585.232.5135
fax: 585.325.8493

www.bergmannpc.com

THE LATEST REVISIONS OF THE STANDARD SHEETS MAINTAINED BY THE DEPARTMENT, WHICH ARE CURRENT ON THE DATE OF ADVERTISEMENT FOR BIDS, SHALL BE CONSIDERED TO BE IN EFFECT. ALL PAY ITEMS AND WORK CONTAINED IN THE CONTRACT AND ANY ADDITIONAL PAY ITEMS AND WORK ENCOUNTERED DURING THE COURSE OF THE CONTRACT SHALL BE SUBJECT TO THE APPLICABLE STANDARD SHEET(S) UNLESS OTHERWISE SPECIFIED IN THE CONTRACT DOCUMENTS.

ALL WORK CONTEMPLATED UNDER THIS CONTRACT IS TO BE COVERED BY AND IN CONFORMITY WITH THE STANDARD SPECIFICATIONS (AS CUSTOMARY) REFERENCED IN THE CONTRACT PROJECT "PROPOSAL" EXCEPT AS MODIFIED BY THESE PLANS OR BY CHANGES SET FORTH IN THE CONTRACT PROJECT "PROPOSAL."

GENERAL NOTES:

- DESIGN SPECIFICATIONS: AASHTO STANDARD SPECIFICATIONS FOR HIGHWAY BRIDGES - 17TH EDITION, AND THE CURRENT NEW YORK STATE STEEL CONSTRUCTION MANUAL, INCLUDING CURRENT ADDITIONS AND MODIFICATIONS, EXCEPT AS MODIFIED BY THE NEW YORK STATE THRUWAY AUTHORITY THRUWAY STRUCTURES DESIGN MANUAL - FOURTH EDITION AND THESE PLANS.
- MATERIAL AND CONSTRUCTION SPECIFICATIONS: NEW YORK STATE DEPARTMENT OF TRANSPORTATION STANDARD SPECIFICATIONS (U.S. CUSTOMARY) DATED 2016 EXCEPT AS MODIFIED IN THESE PLANS AND THE PROPOSAL.
- PAVEMENT AREAS DISTURBED BY THE CONTRACTOR'S OPERATIONS SHALL BE RESTORED "IN-KIND", A.O.B.E. NO SEPARATE PAYMENT WILL BE MADE FOR THIS WORK.
- CARE SHALL BE TAKEN TO RETAIN NATURAL GROWTH AND PREVENT DAMAGE TO TREES WITHIN AND OUTSIDE THE LIMITS OF CONSTRUCTION AND NOT SCHEDULED FOR REMOVAL. ANY DAMAGE CAUSED TO THIS NATURAL GROWTH SHALL BE RESTORED AT THE EXPENSE OF THE CONTRACTOR AS DIRECTED BY THE ENGINEER.
- ALL ELEVATIONS SHOWN ARE BASED ON NAVD 88

SOIL AND EROSION CONTROL NOTES:

- ALL TEMPORARY EROSION AND SEDIMENT CONTROL MEASURES MUST BE IMPLEMENTED, INSPECTED, MONITORED AND MAINTAINED AS SPECIFIED IN THE NYSOT SPECIFICATIONS.
- THE LOCATIONS OF EROSION AND SEDIMENT CONTROL MEASURES, AS INDICATED IN THE CONTRACT DOCUMENTS MAY REQUIRE FIELD ADJUSTMENTS DEPENDING ON THE SEQUENCE OF CONSTRUCTION ACTIVITIES, CONSTRUCTION METHODS AND/OR ACTUAL FIELD CONDITIONS.
- THE ENGINEER IN CHARGE SHALL BE NOTIFIED OF ANY SIGNIFICANT CHANGES TO THE EROSION AND SEDIMENT CONTROL MEASURES INDICATED IN THE CONTRACT DOCUMENTS.
- THE CONTRACTOR SHALL SUBMIT FOR APPROVAL TO THE ENGINEER IN CHARGE HIS WRITTEN SCHEDULE AND PROPOSED MEASURES FOR TEMPORARY AND PERMANENT EROSION AND SEDIMENT CONTROL WORK AND SCHEDULE OF OPERATIONS AS REQUIRED BY SECTION 209 OF THE NYSOT STANDARD SPECIFICATIONS.
- ALL DREDGED AND EXCAVATED MATERIAL THAT IS DISPOSED OF ON AN UPLAND SITE SHALL BE SUITABLY STABILIZED WITH SEED AND MULCH IN ACCORDANCE WITH SECTION 209 OF THE NYSOT STANDARD SPECIFICATIONS SO THAT IT CANNOT REASONABLY RE-ENTER ANY WATER BODY OR WETLAND AREA.
- INSPECTION, PERIODIC CLEANING AND MAINTENANCE OF TEMPORARY SOIL EROSION AND POLLUTION CONTROL DEVICES SHALL BE PERFORMED ON A SCHEDULED BASIS IN ACCORDANCE WITH SECTION 209 OF THE NYSOT STANDARD SPECIFICATIONS. THE COST OF INSTALLING, CLEANING AND REMOVING TEMPORARY SOIL EROSION AND WATER POLLUTION CONTROL DEVICES SHALL BE PAID FOR UNDER THE ITEMS SHOWN.
- ALL CONTROL MEASURES SHALL BE PLACED PRIOR TO STARTING EARTH WORK OPERATIONS AND SHALL REMAIN IN PLACE UNTIL THE NEW SLOPES ARE STABILIZED WITH SEEDING, MULCH AND/OR SLOPE PROTECTION, IN ACCORDANCE WITH SECTION 209 OF THE NYSOT STANDARD SPECIFICATIONS.
- REFER TO NYSOT STANDARD SHEETS 209-01, 209-05, AND 209-06 FOR SOIL AND SEDIMENT CONTROL DETAILS.
- THE CONTRACTOR SHALL MAINTAIN EXISTING DRAINAGE PATTERNS DURING ALL PHASES OF CONSTRUCTION.
- SILT FENCING MUST BE INSTALLED PARALLEL TO EXISTING CONTOURS OR CONSTRUCTED IN LEVEL ALIGNMENTS.
- THE ENGINEER IN CHARGE MAY CALL FOR ADDITIONAL SILT FENCE AND/OR REDRESSING OF CONSTRUCTION ENTRANCES WHERE MEASURES ARE NOT PERFORMING SATISFACTORILY.
- IF CONSTRUCTION ACTIVITIES ARE DISCONTINUED IN AREAS OF SOIL DISTURBANCE/STORAGE BEFORE FINAL GRADING IS COMPLETE, THEN TEMPORARY GRADING SHALL INCLUDE TEMPORARY SEEDING AND MULCH (ITEM 209.1003) THAT WILL BE STABILIZED WITHIN 7 DAYS OF EXPOSURE. MULCH SHALL BE MAINTAINED UNTIL SUITABLE VEGETATIVE COVER IS ESTABLISHED. THIS PAY ITEM IS ESTIMATED AND THE QUANTITY MAY VARY BASED ON ACTUAL CONSTRUCTION CONDITIONS.
- ADDITIONAL QUANTITIES FOR EROSION CONTROL MEASURES MAY BE REQUIRED A.O.B.E. IN ADDITION TO THAT SHOWN. PAYMENT FOR ADDITIONAL WORK SHALL BE MADE UNDER THE APPROPRIATE ITEMS IN THE CONTRACT.
- ANY TEMPORARY STOCKPILES OF TOPSOIL OR FILL WITH SILT FENCES AS SHOWN IN THE SILT FENCE DETAIL IN THE NYSOT STANDARD SHEETS AND STANDARD SPECIFICATIONS. PILES EXPOSED FOR LONGER THAN TWO WEEKS SHALL BE STABILIZED BY SEEDING, MULCH AND/OR SLOPE PROTECTION IN ACCORDANCE WITH SECTION 209 OF THE NYSOT STANDARD SPECIFICATIONS.
- ALL METHODS AND EQUIPMENT PROPOSED BY THE CONTRACTOR TO ACCOMPLISH THE WORK SHALL BE SUBJECT TO THE APPROVAL OF THE ENGINEER IN CHARGE.
- AT THE COMPLETION OF CONSTRUCTION AND PERMANENT SOIL STABILIZATION, SEDIMENT SHALL BE REMOVED FROM TEMPORARY EROSION AND SEDIMENT CONTROL MEASURES. THE COST FOR SEDIMENT REMOVAL, AND GROUND RESTORATION REQUIRED AS A RESULT OF ANY SEDIMENT BUILD-UP SHALL BE INCLUDED IN THE COST BID FOR THE EROSION CONTROL ITEMS.

ENVIRONMENTAL PROTECTION NOTES:

- STREAM CONSERVATION: THE CONTRACTOR SHALL CONDUCT HIS/HER OPERATIONS TO THE SATISFACTION OF THE ENGINEER TO PREVENT OR REDUCE TO A MINIMUM ANY DAMAGE TO ANY WATERWAY FROM POLLUTION BY DEBRIS, SEDIMENT, OR OTHER FOREIGN MATERIAL, OR FROM THE MANIPULATION OF EQUIPMENT AND/OR MATERIALS IN OR NEAR THE WATERWAY. THE CONTRACTOR SHALL NOT RETURN DIRECTLY TO A STREAM, OR TO A DITCH IMMEDIATELY FLOWING INTO A STREAM, ANY WATER WHICH HAS BEEN USED FOR WASH PURPOSES OR OTHER SIMILAR OPERATIONS WHICH COULD CAUSE THIS WATER TO BECOME POLLUTED WITH SAND, SILT, CEMENT, OIL, OR OTHER IMPURITIES. IF THE CONTRACTOR USES WATER FROM A STREAM, HE/SHE SHALL CONSTRUCT AN INTAKE OR TEMPORARY DAM TO PROTECT AND MAINTAIN WATER RIGHTS AND TO SUSTAIN FISH LIFE DOWNSTREAM. THESE TEMPORARY MEASURES SHALL BE REMOVED AND THE AREA RESTORED AT THE COMPLETION OF THE WORK.
- VISIBLY TURBID DISCHARGES FROM DEWATERING OPERATIONS OR EXCAVATION ACTIVITIES SHALL NOT BE ALLOWED TO ENTER ANY WATERWAY. THE CONTRACTOR SHALL BE RESPONSIBLE FOR ALL MEASURES NECESSARY TO ELIMINATE THE TURBIDITY PRIOR TO DISCHARGE.
- SPILLAGE OF OIL AND HAZARDOUS SUBSTANCES IS ESPECIALLY PROHIBITED BY SECTION 311 OF THE CLEAN WATER ACT OF 1977. MEASURES INCLUDING PROPER MAINTENANCE OF CONSTRUCTION EQUIPMENT, DESIGNATING FUEL/HAZARDOUS SUBSTANCES HANDLING AREAS TO ALLOW SPILLS TO BE CONTAINED BEFORE REACHING THE WATERWAY, INSTRUCTING PERSONNEL NOT TO DISPOSE OF OIL AND OTHER SUCH MATERIALS INTO DRAINS OR INTO THE WATERWAY DIRECTLY, AND OTHER NECESSARY PROCEDURES SHALL BE IMPLEMENTED PRIOR TO ANY CONSTRUCTION ACTIVITIES. IF, IN SPITE OF SUCH PLANNING, OIL/HAZARDOUS SUBSTANCES ARE SPILLED INTO A WATER COURSE, IMMEDIATE NOTIFICATION SHALL BE GIVEN TO THE NEW YORK STATE DEPARTMENT OF ENVIRONMENTAL CONSERVATION AT TELEPHONE NUMBER (518)-457-7362, THE NATIONAL RESPONSE CENTER AT TELEPHONE NUMBER 1-800-424-8802 AND THE CANAL CORPORATION SENIOR DISPATCHER AT 866-691-8282. A CONTAINMENT BOOM AND A SUPPLY OF HAY, STRAW, OR OTHER ABSORBENT SHOULD BE RETAINED ON SITE SO THAT IT MAY BE RAPIDLY DEPLOYED TO SOAK UP ANY POSSIBLE SPILLAGE, PENDING DEPARTMENT OF ENVIRONMENTAL CONSERVATION AND/OR COAST GUARD ARRIVAL ON THE SCENE. THE USE OF CHEMICAL DISPERSING AGENTS AND EMULSIFIERS IS NOT AUTHORIZED WITHOUT PRIOR SPECIFIC FEDERAL OR STATE APPROVAL. THE COST OF SUCH MEASURES SHALL BE PAID FOR UNDER THE VARIOUS ITEMS OF THE CONTRACT.
- THE WORK IN THIS CONTRACT COMPLIES WITH U.S. ARMY CORPS OF ENGINEERS (USACE) NATIONWIDE PERMIT (NWP) 3. THE REQUIRED NOTIFICATION HAS BEEN MADE TO THE USACE. A NEW YORK STATE DEPARTMENT OF ENVIRONMENTAL CONSERVATION (NYSDEC) WATER QUALITY CERTIFICATION (WQC) HAS BEEN ISSUED FOR USACE, NWP'S. THE CONTRACTOR SHALL COMPLY WITH ALL THE PROVISIONS OF THE NWP'S INCLUDING ANY REGIONAL CONDITIONS, AND ASSOCIATED WQC'S.
- PROTECTION OF INDIANA BATS AND NORTHERN LONG-EARED BATS: DUE TO THE POSSIBILITY OF THE FEDERAL-LISTED ENDANGERED INDIANA BAT AND NORTHERN LONG-EARED BAT OCCURRING IN THE PROJECT VICINITY, THE CONTRACTOR SHALL CUT TREES LARGER THAN 3 INCHES IN DIAMETER AT BREAST HEIGHT (DBH), ONLY BETWEEN OCTOBER 1ST AND MARCH 31ST. OUTSIDE OF THESE DATES, THE INDIANA BAT AND NORTHERN LONG-EARED BAT MAY BE UTILIZING TREES OF THIS SIZE FOR ROOSTING AND BREEDING PURPOSES, AND SHOULD NOT BE DISTURBED OR HARMED BY TREE REMOVAL.

UTILITY NOTES:

- THE CONTRACTOR SHALL CONTACT DIG SAFELY NEW YORK IN ADVANCE OF ANY DIGGING TO AVOID INTERRUPTION OF SERVICE PROVIDED BY UNDERGROUND UTILITIES. THE PHONE NUMBER IS 811.
- SHOULD UTILITIES BE ENCOUNTERED DURING CONSTRUCTION WHICH INTERFERE WITH THE WORK AND FOR WHICH PROVISIONS ARE NOT PROVIDED ON THE PLANS, THE CONTRACTOR SHALL IMMEDIATELY NOTIFY THE ENGINEER OF THEIR EXISTENCE AND EXTENT OF CONFLICT WITH THE WORK. THE CONTRACTOR SHALL MAKE ARRANGEMENTS WITH THE OWNING AGENCY TO MODIFY ITS FACILITY IN ORDER TO ALLOW THE WORK TO PROGRESS. ANY ADJUSTMENTS TO CONTRACT QUANTITIES AS A RESULT OF SUCH UTILITY CONFLICTS WILL BE PAID FOR AT CONTRACT UNIT PRICES.
- LOCATION OF UTILITIES, PUBLIC AND/OR PRIVATE, INDICATED AS EXISTING AND/OR TO BE CONSTRUCTED AS SHOWN ON THE PLANS, ARE APPROXIMATE ONLY. THEIR EXACT LOCATION SHALL BE DETERMINED IN THE FIELD. ADDITIONAL UTILITY LINES, WHETHER ABANDONED OR IN SERVICE, MAY EXIST AND IT SHALL BE THE CONTRACTOR'S RESPONSIBILITY TO CONDUCT HIS OPERATIONS AND TAKE THE NECESSARY PRECAUTIONS TO PREVENT INTERFERENCE WITH OR DAMAGE TO THESE OR OTHER FACILITIES DURING THE COURSE OF CONSTRUCTION.
- SPECIAL CARE SHALL BE TAKEN TO AVOID DAMAGING EXISTING UTILITIES AND GAUGES. ANY DAMAGE CAUSED BY THE CONTRACTOR'S OPERATIONS SHALL BE REPAIRED BY THE CONTRACTOR AT NO COST TO THE CANAL CORPORATION.
- IN THE EVENT THE CONTRACTOR DAMAGES AN EXISTING UTILITY SERVICE, CAUSING AN INTERRUPTION IN SAID SERVICE, HE/SHE SHALL IMMEDIATELY COMMENCE WORK TO RESTORE SERVICE AND MAY NOT CEASE HIS/HER WORK OPERATION UNTIL SERVICE IS RESTORED.

WATER CONTROL NOTES:

- RESERVOIR STORAGE CAPACITY

ELEVATION (FT)	STORAGE (ACRE-FT)	STAGE
1751.5	0	PRINCIPAL INTAKE (NORMAL W.S.)
1771.5	590	RISE INTAKE (UNDER)
1782.4	1250	AUXILIARY SPILLWAY
1788.7	1920	TOP OF DAM
- DEWATERING OF EACH PHASE SHALL BE ACCOMPLISHED BY DIVERTING EXIT FLOW FROM THE END OF THE PRINCIPAL SPILLWAY PIPE, AROUND THE WORK AREA.
- THE CONTRACTOR SHALL, AT ALL TIMES BE ABLE TO REMOVE BLOCK FROM LOW LEVEL PRINCIPAL OUTLET, IF APPLIED TEMPORARILY.
- DIVERSION WILL EMPTY BACK INTO STREAM PAST THE PLUNGE POOL.
- IF A HIGH WATER EVENT IS EXPECTED, THE CONTRACTOR WILL ASSURE FREE FLOW THROUGH THE PRINCIPAL SPILLWAY A.O.B.E.
- DIVERSION STRUCTURE SHALL BE CAPABLE OF DIVERTING 12cfs. FLOWS OVER THAT AMOUNT DURING FLOOD SCENARIOS WILL OVERFLOW THE WORK AREA. THE CONTRACTOR SHALL BE RESPONSIBLE FOR ALL EQUIPMENT AND NON-INSTALLED MATERIAL LEFT IN THE WORK AREA.

DAM SAFETY NOTES:

- CONTRACTOR IS TO ABIDE BY THE DEC DAM SAFETY PERMIT (SUPPLEMENT D-1 TO THE JOINT PERMIT).
- CONTRACTOR IS ADVISED THAT DAM 5 IS AN OPERATING WATER RETAINING STRUCTURE AND WILL REMAIN FUNCTIONAL DURING CONSTRUCTION.
- IF AT ANY POINT IN TIME SEDIMENT LADEN WATER IS SEEN PROTRUDING FROM THE DAM, THE ENGINEER SHALL BE CONTACTED IMMEDIATELY. THE ENGINEER MAY STOP ALL WORK OR ORDER REPAIRS AT THAT TIME.
- THE CONTRACTOR SHALL KEEP 10 CY OF EMBANKMENT IN PLACE MATERIAL (ITEM 203.03) ON SITE AT ALL TIMES.
- THE CONTRACTOR SHALL KEEP 30 SAND BAGS FILLED AND READY FOR DEPLOYMENT AT ALL TIMES IN THE EVENT OF AN EMERGENCY. TO BE INCLUDED IN COST FOR ITEM 203.03.
- CONTRACTOR IS ADVISED TO BE IN DAILY CONTACT WITH NATIONAL WEATHER SERVICE REGARDING STORM EVENTS AND RESERVOIR LEVELS FOR APPLICABLE STAGES OF CONSTRUCTION. IN THE EVENT OF A RAIN FORECAST EXCEEDING 2" WITHIN 24 HOURS ANYWHERE IN CATTARAUGUS COUNTY THE CONTRACTOR SHALL STOP WORK. WORK SHALL NOT RECOMMENCE UNTIL THE ENGINEER APPROVES.
- IF AN EMERGENCY SITUATION DEVELOPS COMPROMISING THE INTEGRITY OF THE DAM, THE CONTRACTOR OR ENGINEER SHALL IMMEDIATELY NOTIFY THE ENGINEER AT THE FOLLOWING NUMBER IN ORDER TO INITIATE THE EMERGENCY ACTION PLAN FOR THE DAM:
A. JAMES R. GUISTINA, P.E. - BERGMANN PHONE: (585) 498-7826
- THE EIC WILL KEEP A COPY OF THE EMERGENCY ACTION PLAN ON SITE AT ALL TIMES.
- ANY DAM SAFETY INCIDENT SHALL BE LOGGED PER THE EMERGENCY ACTION PLAN.

HIGHWAY PERMIT:

- THE CONTRACTOR IS ADVISED THAT A HIGHWAY PERMIT WILL BE REQUIRED FROM THE TOWN OF LYDON. THE APPLICATION SHOULD BE SUBMITTED AT LEAST 3 WEEKS PRIOR TO THE START OF WORK. SEE DETAIL THIS SHEET FOR MPT DETAIL.

REMOVAL, EXCAVATION, AND BACKFILL NOTES:

- DURING REMOVAL OPERATIONS, THE CONTRACTOR SHALL NOT DROP WASTE CONCRETE, DEBRIS, OR OTHER MATERIAL INTO ANY WATER BODY. PLATFORMS, NETS, SCREENS, OR OTHER PROTECTIVE DEVICES SHALL BE USED TO CATCH AND RETRIEVE THE MATERIAL. IF THE ENGINEER DETERMINES THAT ADEQUATE PROTECTIVE DEVICES ARE NOT BEING EMPLOYED, THE WORK SHALL BE SUSPENDED UNTIL ADEQUATE PROTECTION IS PROVIDED. IF MATERIAL FALLS ON THE AREA BELOW OR ADJACENT TO THE STRUCTURES, IT SHALL BE REMOVED AND DISPOSED OF BY THE CONTRACTOR ON A REGULAR DAILY BASIS.
- THE COST OF FURNISHING, INSTALLING, MAINTAINING, REMOVING, AND DISPOSING OF ALL PLATFORMS, NETS, SCREENS, AND OTHER PROTECTIVE DEVICES, SHALL BE INCLUDED IN THE UNIT BID PRICES OF THE APPROPRIATE ITEMS IN THE CONTRACT.
- CARE SHALL BE TAKEN TO RETAIN NATURAL GROWTH AND PREVENT DAMAGE TO TREES WITHIN AND OUTSIDE THE LIMITS OF CONSTRUCTION, AND NOT SCHEDULED FOR REMOVAL. ANY DAMAGE CAUSED TO THIS NATURAL GROWTH SHALL BE RESTORED AT THE EXPENSE OF THE CONTRACTOR, AS DIRECTED BY THE ENGINEER.
- THE CONTRACTOR WILL BE HELD RESPONSIBLE FOR ALL DAMAGE TO THE EXISTING FACILITY CAUSED BY HIS OPERATIONS. ALL DAMAGE TO THE EXISTING FACILITY CAUSED BY THE CONTRACTOR'S OPERATIONS SHALL BE REPAIRED BY THE CONTRACTOR TO THE SATISFACTION OF THE ENGINEER WITHOUT COST TO THE COUNTY.
- THE CONTRACTOR SHALL PERFORM ALL WORK WITH CARE SO THAT ANY MATERIALS THAT ARE TO REMAIN IN PLACE, OR WHICH ARE TO REMAIN THE PROPERTY OF THE CANAL CORPORATION, WILL NOT BE DAMAGED. IF THE CONTRACTOR DAMAGES ANY SUCH MATERIAL, THE DAMAGED MATERIALS SHALL BE REPAIRED OR REPLACED IN A MANNER SATISFACTORY TO THE ENGINEER WITHOUT COST TO THE COUNTY.

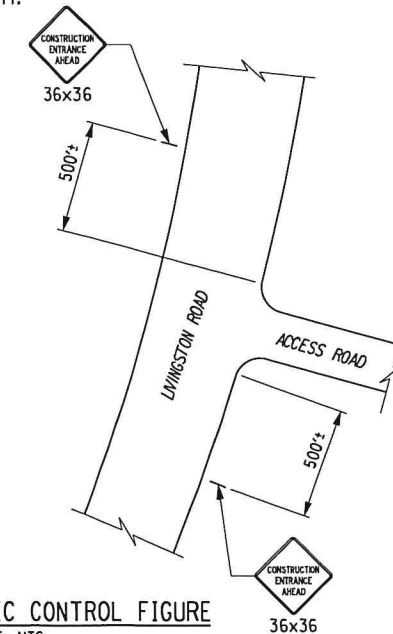

WORK ZONE TRAFFIC CONTROL FIGURE
SCALE: NTS
ITEM NO. 619.0101

**ISCHUA 5
PLUNGE POOL
REHABILITATION**

Town of Lydon
Cattaraugus County



280 East Broad Street
Suite 200
Rochester, New York 14604
office: 585.232.5135
fax: 585.325.8493
www.bergmannpc.com

REVISIONS			
NO.	DATE	DESCRIPTION	REV. CK'D

The underground structures and utilities shown on this drawing have been plotted from available surveys or utility record maps. They are not certified to the accuracy of their location or their completeness. It is the Contractor's responsibility to verify the location and extent of all underground structures and utilities.

Date

GENERAL NOTES

Unauthorized alteration or addition to this drawing is a violation of the New York State Education Law Article 145, Section 7209.

Project Manager: JRG
Designed By: JRG
Drawn By: MRH
Checked By: JRG
Drawing Number: **GN-1**

Project Number: 1083100
Date Issued: JANUARY 2019
Scale: AS NOTED

GN-1

ISCHUA 5 PLUNGE POOL REHABILITATION

Town of Lyndon
Cattaraugus County

B BERGMANN
ARCHITECTS ENGINEERS PLANNERS

280 East Broad Street
Suite 200
Rochester, New York 14604

office: 585.232.5135
fax: 585.325.8493

www.bergmannpc.com

REVISIONS				
NO.	DATE	DESCRIPTION	REV.	CKD

The underground structures and utilities shown on this drawing have been plotted from available surveys or utility record maps. They are not certified to the accuracy of their location or their completeness. It is the Contractor's responsibility to verify the location and extent of all underground structures and utilities.

Date _____

SITE AND EROSION CONTROL PLAN

Unauthorized alteration or addition to this drawing is a violation of the New York State Education Law Article 145, Section 7209.

Project Manager: JRG
 Designed By: JRG
 Drawn By: MRH
 Checked By: JRG
 Drawing Number: **SP-1**

Project Number: 1083100
 Date Issued: JANUARY 2019
 Scale: AS NOTED

SP-1



SITE PLAN
SCALE: 1"=50'

LEGEND

- ◆◆ SILT FENCE, ITEM 209.13
- TURBIDITY CURTAIN, ITEM 209.1501
-]E[ELECTRIC OVERHEAD LINES
- APL — APPROXIMATE EASEMENT
- WATER DIVERSION ITEM 553.030001 SEE NOTES GN-1 (OPTIONAL)

ISCHUA 5 PLUNGE POOL REHABILITATION

Town of Lyndon
Cattaraugus County

B BERGMANN
ARCHITECTS ENGINEERS PLANNERS

280 East Broad Street
Suite 200
Rochester, New York 14604

office: 585.232.5135
fax: 585.325.8493

www.bergmannpc.com

REVISIONS				
NO.	DATE	DESCRIPTION	REV.	CKD

The underground structures and utilities shown on this drawing have been plotted from available surveys or utility record maps. They are not certified to the accuracy of their location or their completeness. It is the Contractor's responsibility to verify the location and extent of all underground structures and utilities.

Date

GENERAL PLAN

Unauthorized alteration or addition to this drawing is a violation of the New York State Education Law Article 145, Section 7209.

Project Manager:
JRG
Designed By: JRG
Drawn By: MRH
Checked By: JRG
Drawing Number:

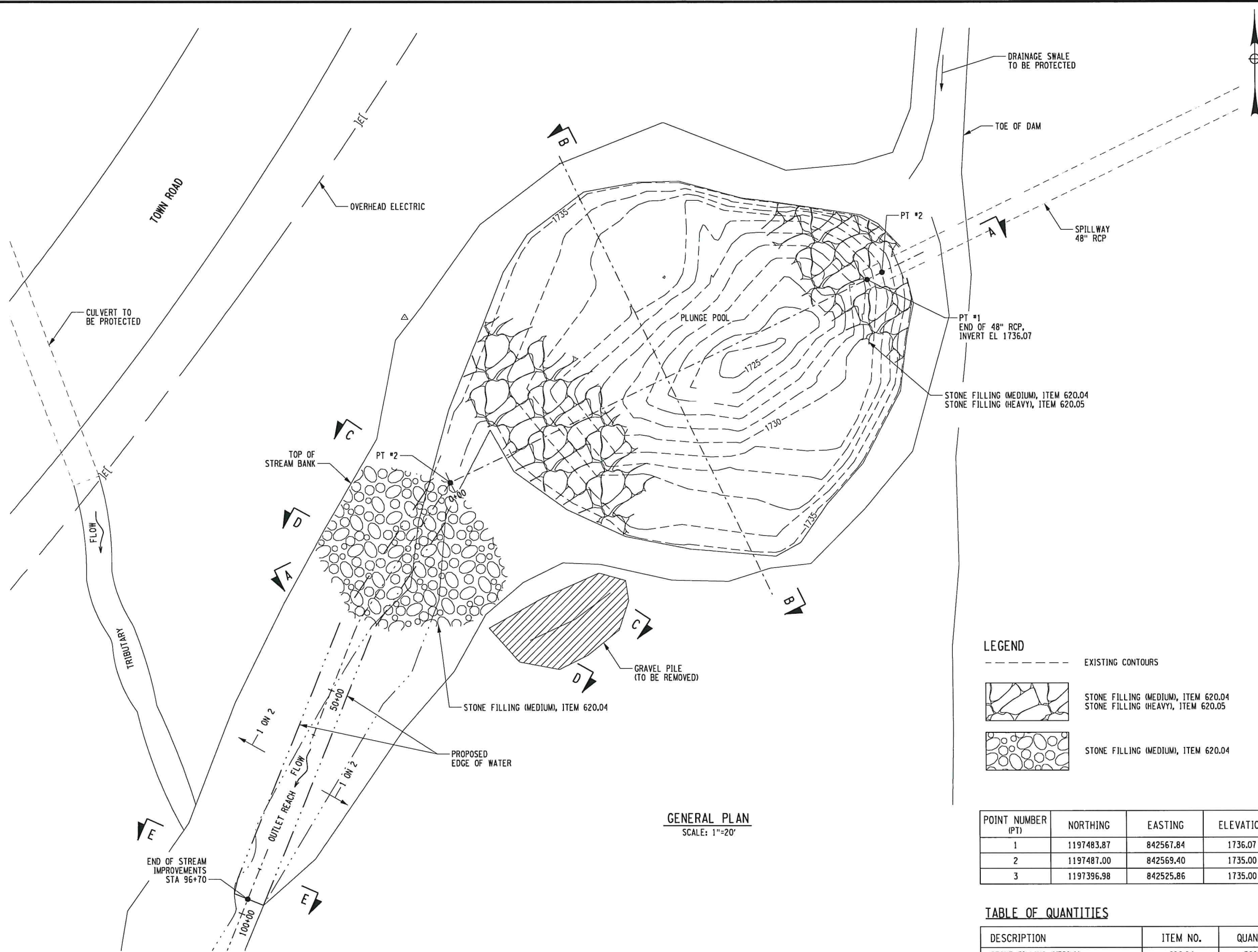

Project Number:
1083100
Date Issued:
JANUARY 2019
Scale:
AS NOTED

GP-1



GENERAL PLAN
SCALE: 1"=20'

LEGEND

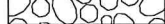
-  EXISTING CONTOURS
-  STONE FILLING (MEDIUM), ITEM 620.04
-  STONE FILLING (HEAVY), ITEM 620.05
-  STONE FILLING (MEDIUM), ITEM 620.04

POINT NUMBER (PT)	NORTHING	EASTING	ELEVATION
1	1197483.87	842567.84	1736.07
2	1197487.00	842569.40	1735.00
3	1197396.98	842525.86	1735.00

TABLE OF QUANTITIES

DESCRIPTION	ITEM NO.	QUANTITY
STONE FILLING (MEDIUM)	620.04	300 CY
STONE FILLING (HEAVY)	620.05	440 CY

ISCHUA 5 PLUNGE POOL REHABILITATION

Town of Lyndon
Cattaraugus County



280 East Broad Street
Suite 200
Rochester, New York 14604

office: 585.232.5135
fax: 585.325.8493

www.bergmannpc.com

REVISIONS				
NO.	DATE	DESCRIPTION	REV.	CK'D

The underground structures and utilities shown on this drawing have been plotted from available surveys or utility record maps. They are not certified to the accuracy of their location or their completeness. It is the Contractor's responsibility to verify the location and extent of all underground structures and utilities.

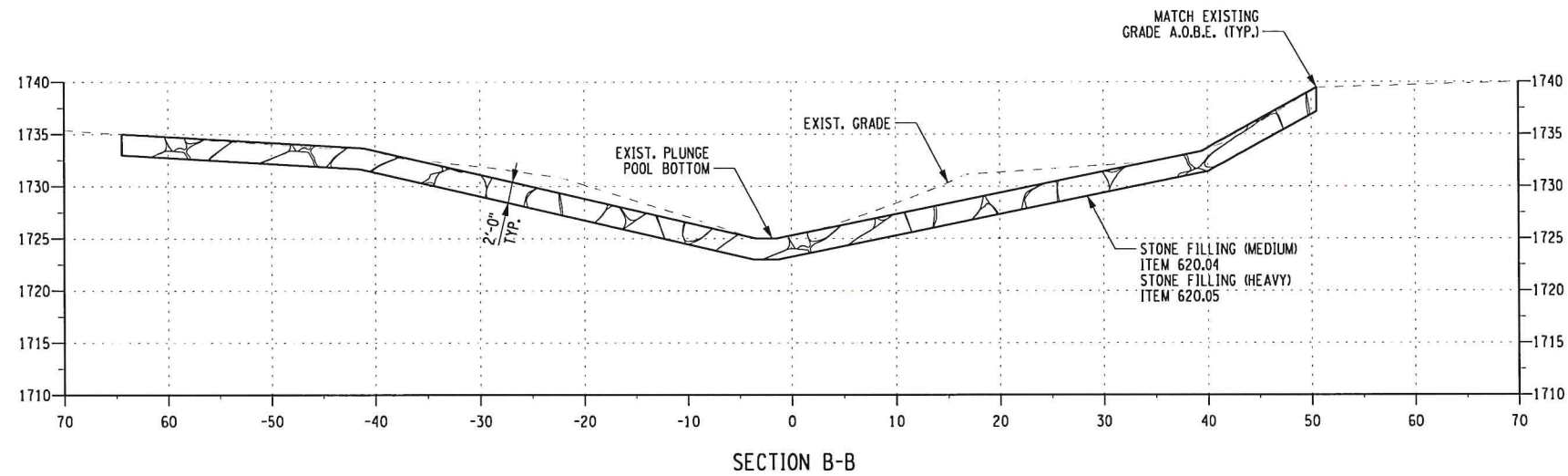
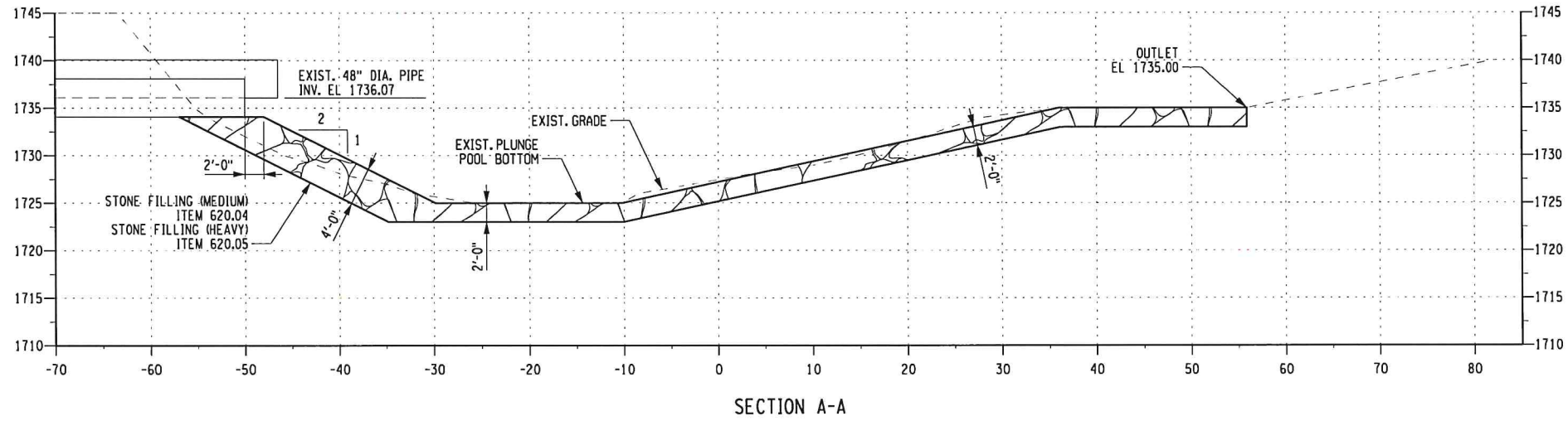

LEGEND

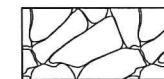

STONE FILLING (MEDIUM), ITEM 620.04
STONE FILLING (HEAVY), ITEM 620.05

Print Date: DGN\$SYTIME0123456
File Name: DGN\$FILENAME0123456

CROSS SECTIONS - 1

Unauthorized alteration or addition to this drawing is a violation of the New York State Education Law Article 145, Section 7209.

Project Manager: JRG
Designed By: JRG
Drawn By: MRH
Checked By: JRG
Drawing Number: _____

Project Number: 1083100
Date Issued: JANUARY 2019
Scale: AS NOTED

XS-1

ISCHUA 5 PLUNGE POOL REHABILITATION

Town of Lyndon
Cattaraugus County



280 East Broad Street
Suite 200
Rochester, New York 14604

office: 585.232.5135
fax: 585.325.8493

www.bergmannpc.com

REVISIONS				
NO.	DATE	DESCRIPTION	REV.	CKD

The underground structures and utilities shown on this drawing have been plotted from available surveys or utility record maps. They are not certified to the accuracy of their location or their completeness. It is the Contractor's responsibility to verify the location and extent of all underground structures and utilities.

Date

CROSS SECTIONS - 2

Unauthorized alteration or addition to this drawing is a violation of the New York State Education Law Article 145, Section 7209.

Project Manager: JRG
 Designed By: JRG
 Drawn By: MRH
 Checked By: JRG
 Project Number: 1083100
 Date Issued: JANUARY 2019
 Scale: AS NOTED

Drawing Number:

XS-2

